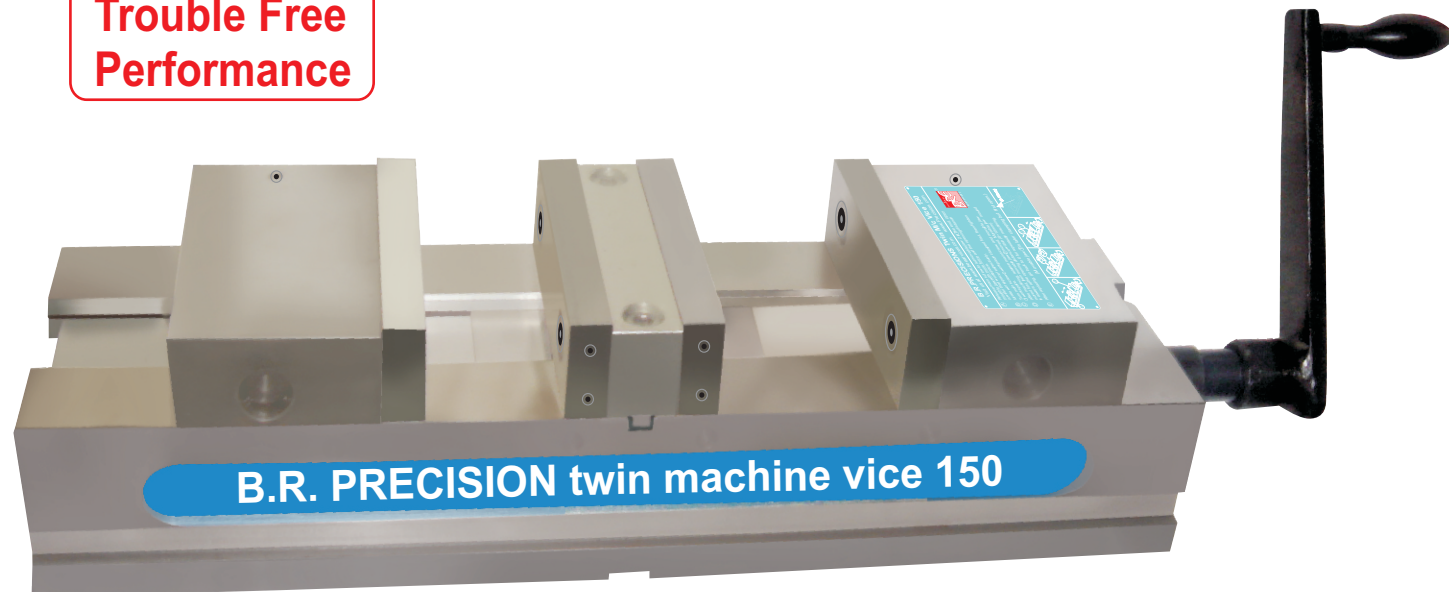

**B.R. PRECISION TWIN MACHINE VICE****Model Type: BR - TWIN - 150****Trouble Free  
Performance****B.R. PRECISION twin machine vice 150****Mechanically Operated****FEATURES****B.R.PRECISION TWIN MACHINE VICE 150:**

One handle can simultaneously operate two movable jaws and clamps 2 pieces of workpiece of same size or different size or one large workpiece, This type of vice is Very use full for Same height or Production House Advantage In this kind of vice the cutting materials are restricted due to the Safety guards in the vice One applicant to be used in the tool room. The cast iron Body is made of high tensile strength material, Tenon Slots are Hardened and Ground This model can increase efficiency and productivity of any HMC, VMC & CNC machine & manual milling machine

Manufacturer:

Sales Office : # 19, TVS CROSS, PEENYA INDUSTRIAL ESTATE I STAGE,  
BANGALORE - 560 058, INDIA

MOB: +91 98452 08854, 094496 48171, 099726 37475, 08722472132

E-mail Id: brvices@rediffmail.com, brprecisions@gmail.com

Visit us at: [www.brprecision.com](http://www.brprecision.com), [www.brvice.com](http://www.brvice.com)

**B.R. TWIN MACHINE VICE****Model Types. & Dimensions****Mechanically Operated**

Specification	Model Type BR-TWIN-150 ↓
Width Of Jaws ( I )	150 mm
Depth of Jaws ( C )	45 mm
Opening Range 'A'	125 mm
Opening Range 'B'	120 mm
Height of Work face ( D )	85 mm
Length from slot to base end ( F )	310 mm
Overall Width of base ( I )	152 mm
Total length ( G )	554 mm
Total length With handle ( H )	664 mm
Total Height ( E )	130 mm
'L' Clamping Base Height ( K )	18 mm
Tenon slot ( J )	18 mm
Weight (App)	45 Kg

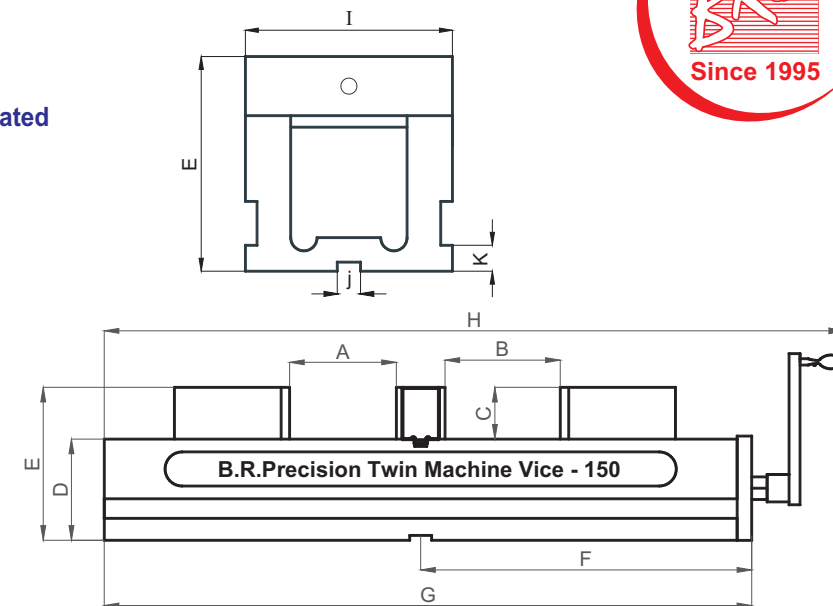
**B.R.PRECISION Twin Machine Vice 150**

- Release main screw to let movable jaw ② to the end. open movable jaw with more force and the opening distance is wider that workspace.
- locate workspace respectively.
- Turn main screw ② workpiece clamped first, then tighten ① workspace.
- After machining, release main screw, and movable jaw move first, then movable jaw ② move. Movable jaw moved is always at the opening distance within (8~10mm).
- After replacing, go back to ③ for repeated machining.

(Movable jaw ① is later clamping but first open.)

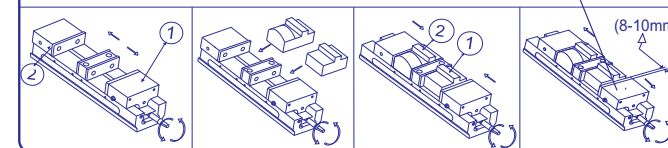

Warranty: One year conditional warranty on manufacturing defects

Visit us at [www.brvice.com](http://www.brvice.com), [www.brprecision.com](http://www.brprecision.com)